

# **Espaço & "Lugar"**



# Arquitetura e “Lugar”

## Edifícios, Interstícios e o Espaço Urbano



Tese apresentada à Faculdade de Arquitetura e Urbanismo da Universidade de São Paulo dentro do curso de Pós-graduação em Estruturas Ambientais Urbanas visando a obtenção do título de Doutor. **São Paulo** 2004

**Orientador** Prof. Dr. Arq. Sylvio Barros Sawaya

**Aluno** Arq. Julio Cezar Bernardes Pinto

Rudolf Arnheim | **Christian Norberg-Schulz** | Aldo Rossi | **Giulio Argan** | Vicent Scully  
**Kent Bloomer e Charles Moore** | José M. R. Garcia Lamas | **Josep Maria Montaner**

#### Leitura Formal Elementos conceituais

1. Eixos -  
Malha organizadora do espaço
2. Massa Edificada - Morfologia
3. Composição Tipológica
4. Simetria – Assimetria
5. Centralidade
6. Verticalidade
7. Técnica construtiva
8. Percepção Espacial

Conceitos relevantes: **Percorso** Caminhar **Estaticidade** Dinamismo **Assimetria** Simetria **Percepção ativa**

### **Categoria Espacial 01** O edifício como objeto solto no espaço

Prevalece a situação do edifício como um elemento autônomo, dominante na paisagem, não configurando o espaço circundante. A definição do lugar está determinada pela referência simbólica da arquitetura e pela qualidade estética da tipologia adotada.

#### **Períodos recorrentes:**

Arquitetura egípcia, grega, romana, bizantina, islâmica, gótica, renascentista e maneirista. Também encontramos exemplos nos séculos XVIII - “Era da Ilustração” -, XIX, e; principalmente, no século XX, neste casos, nas propostas vinculadas ao paradigma funcionalista.

### **Categoria Espacial 02** O edifício desenhando o espaço livre / 1a. situação

Prevalece a idéia da configuração do espaço livre através do agenciamento do edifício. Estabelece-se aqui um dos elementos tipológicos mais característicos da arquitetura: o pátio. A escala arquitetônica adquire uma outra dimensão perceptiva. Passa a existir uma categoria espacial que é responsável pela transição entre o interior e o exterior do edifício.

#### **Períodos recorrentes:**

Arquitetura egípcia, grega, romana, bizantina, islâmica, românica, gótica, renascentista, maneirista e barroca. Encontramos significativos exemplos na arquitetura produzida nos séculos XIX e XX.

### **Categoria Espacial 03** O edifício desenhando o espaço livre / 2a. situação

Prevalece a idéia da configuração do espaço livre através do agenciamento do edifício, mas gerando uma composição mais dinâmica e complexa. Rompe-se a idéia de simetria e ortogonalidade. A dinâmica do espaço está dada pela irregularidade do traçado, dinâmico e instável.

#### **Períodos recorrentes:**

Arquitetura grega, romana, islâmica, românica, maneirista, barroca. Encontramos muitos exemplos significativos na produção arquitetônica pós-moderna - principalmente nas décadas de 60, 70 e 80 - e contemporânea, quando observamos, principalmente, as obras de Daniel Libeskind, Zaha Hadid, Bernard Tschumi e Peter Eisenman.



# Categoria Espacial 01

**Arquitetura Egípcia**

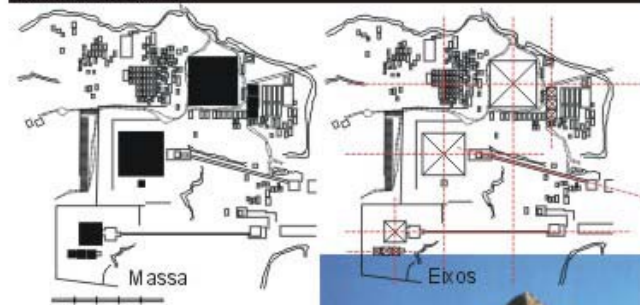

**Gizé. Pirâmides, 2613-2494 a.C.**

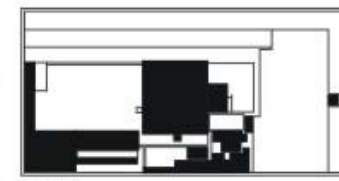

Massa

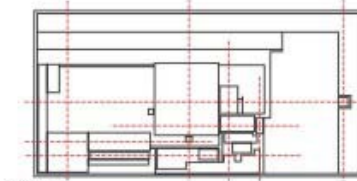

Eixos

**Sakkara. Pirâmide de Zoser, 2778-2723 a.C.**  
Arq. Imhotep



**Arquitetura Islâmica**

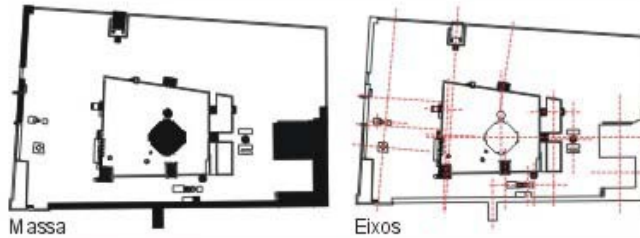

Massa

Eixos



**Jerusalém. Cúpula do Rochedo, 687-692.**  
Califa Abd Al-Malik

**Arquitetura Bizantina**

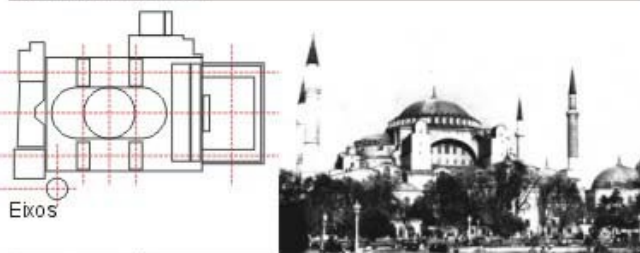

Eixos



**Estambul. Constantinopla. Igreja Santa Sofia, 532-537**

**Arquitetura Gótica**

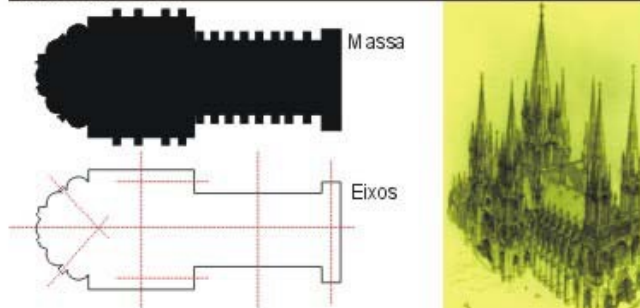

Massa

Eixos

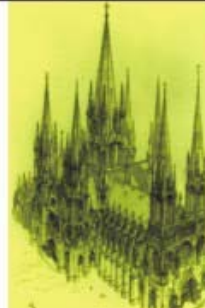

**França. Catedral de Reims, sec. XIII**  
Arq. Jean d'Orbais

Arquitetura Renascentista

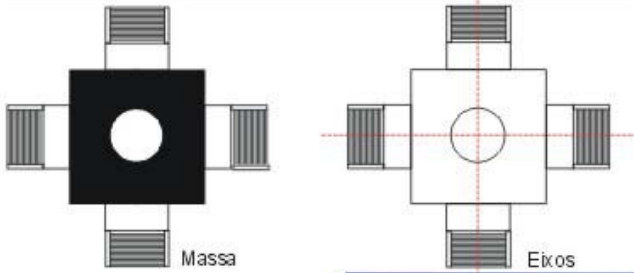

Vicenza. Vila Rotonda, 1566-1570  
Arq. Andrea Palladio



Arquitetura no século XVII - XIX - A Era da Ilustração

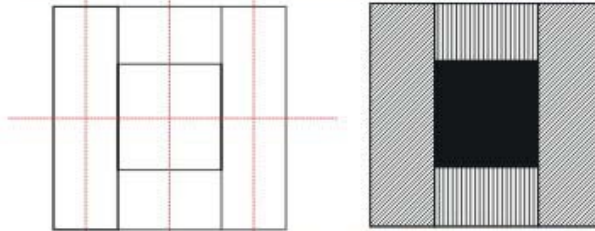

Casa de Guarda Fluvial, 1785  
Arq. Claude-Nicolas Ledoux



Cenotáfio Isaac Newton, 1784  
Arq. Étienne-Louis Boullée

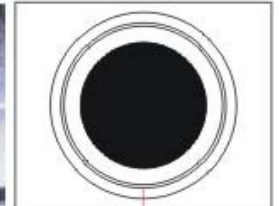

Casa de Guarda Agrícola, 1775  
Arq. Claude-Nicolas Ledoux

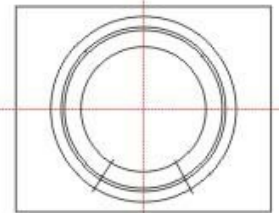

Paris. Barrière de la Villette, 1784-1789  
Arq. Claude-Nicolas Ledoux



Arquitetura no século XX - O Modelo Racionalista

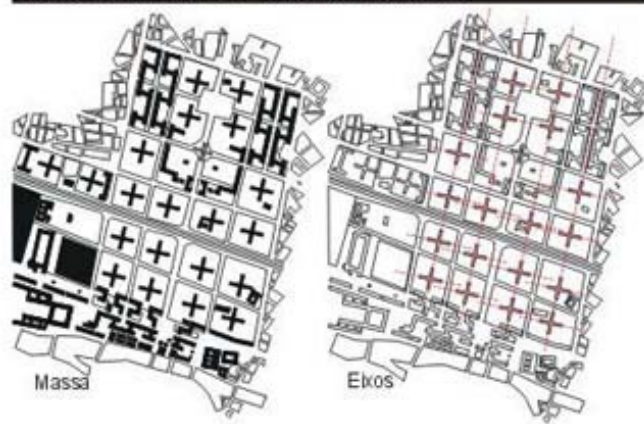

França. Plano Voisin Paris, 1925  
Arq. Le Corbusier

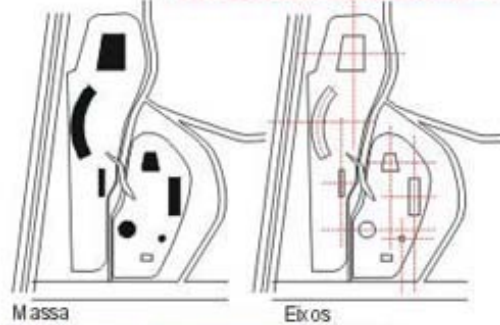

São Paulo.  
Memorial da América Latina, 1989  
Arq. Oscar Niemeyer



Arquitetura Moderna

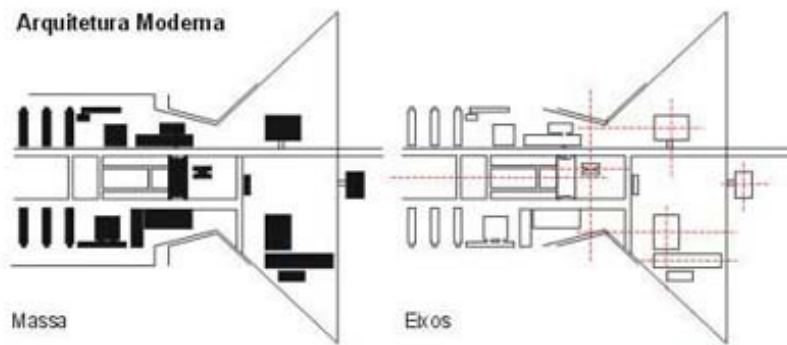

Brasília. Praça dos Três Poderes, 1960  
Arq. Lúcio Costa

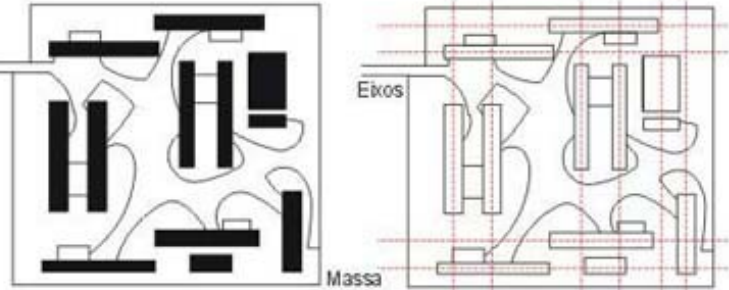

Brasília. Super Quadra, 1960  
Arq. Lúcio Costa





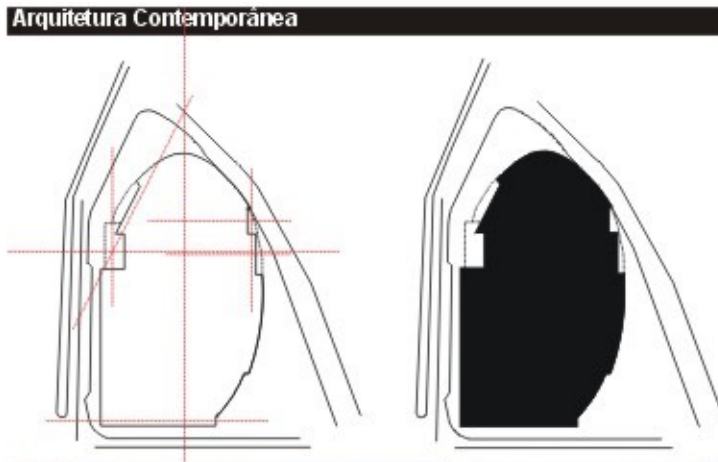

**França. Lille - Congrexpo, 1990-94**  
Arq. Rem Koolhaas

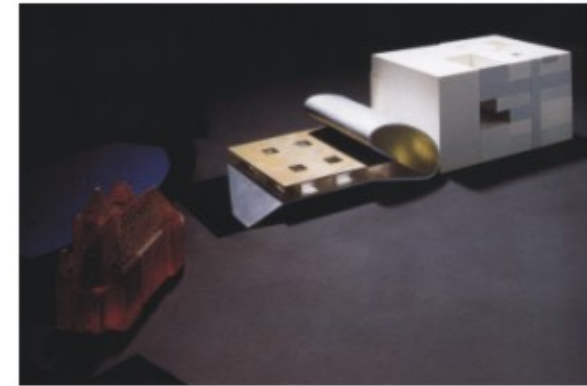
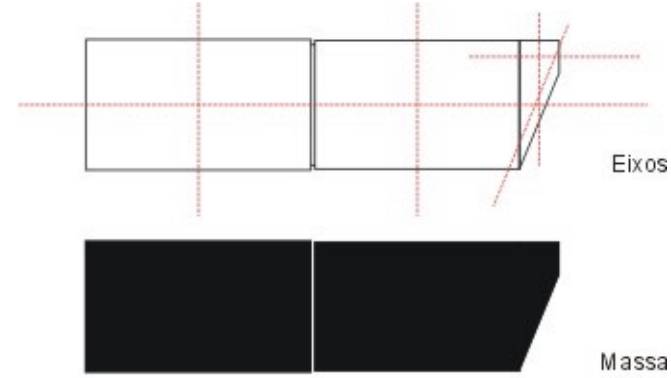
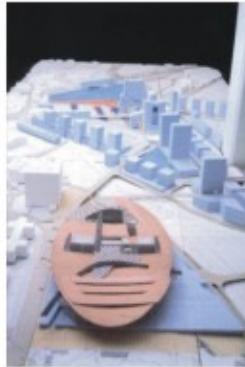

**Reino Unido. País de Gales - Ópera Cardiff, 1994**  
Arq. Rem Koolhaas

# Categoria Espacial 02

## Arquitetura Egípcia



Tebas. Carnaque.  
Complexo de Amón, 2000 a.C.

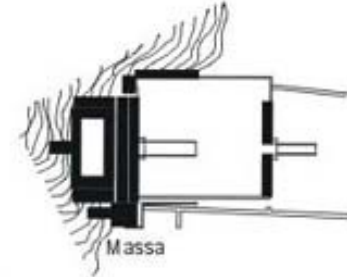
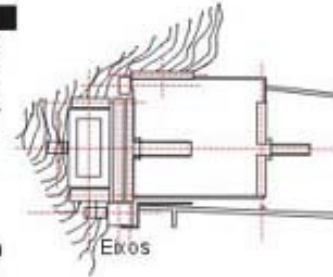

Templo funerário da Rainha Hatshepsut  
Deir el-Bahari, 1470 a.C.



## Arquitetura Grega

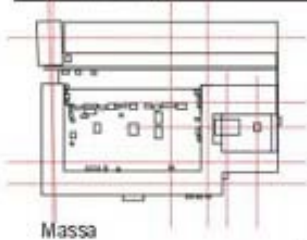

Massa

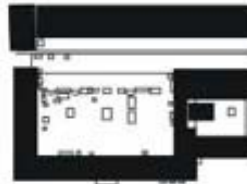

Eikos



Priene - Ágora, sec. II a.C.



Delos  
Santuário da deusa súa, sec. II a.C.

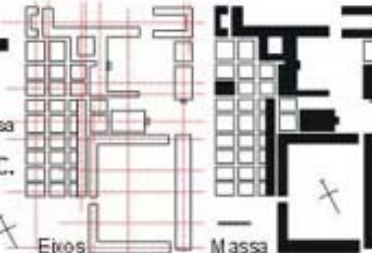

Mileto - Edifícios públicos, 479 a.C.

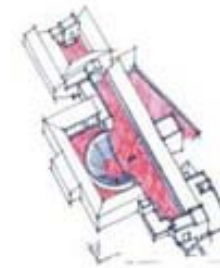

Mileto. Casa do Conselho

## Arquitetura Romana



Massa



Fórum de Pompéia - Arco de Nero

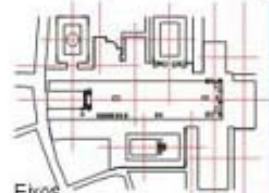

Eikos



Timgad

Cidade Romana de Timgad, 100 d.C.

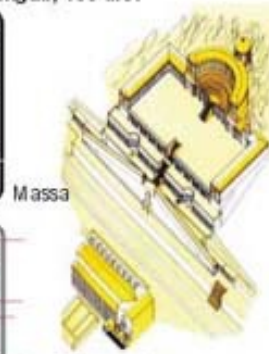
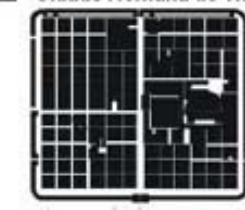

Massa



Eikos

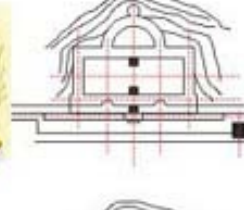

Praeneste  
Templo da Fortuna Primigenia, 80 a.C.

## Arquitetura Islâmica

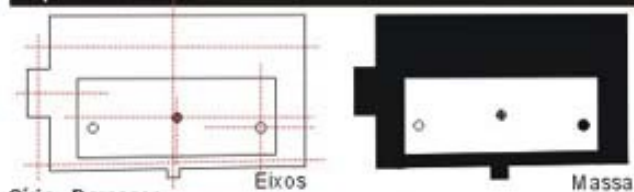

Síria - Damasco.  
A Grande Mesquita de Damasco, 707-14

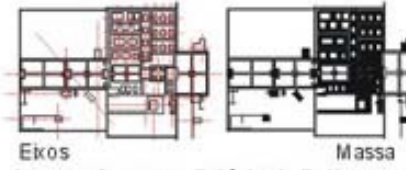

Iraque - Samarra. Palácio de Bulwar, 850-60

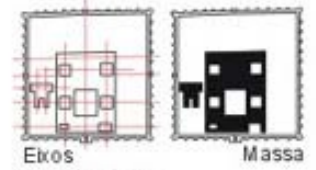

Mesopotâmia  
Palácio de Ukhaidir, 778



## Arquitetura Bizantina

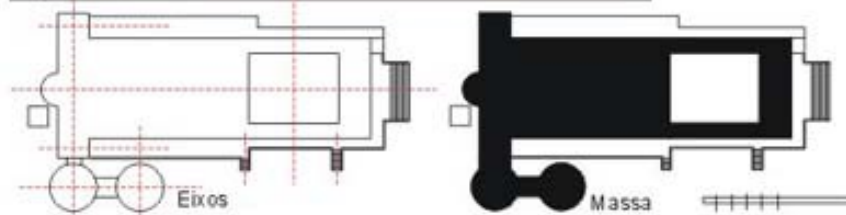

Roma - Antiga Basílica de São Pedro, 324

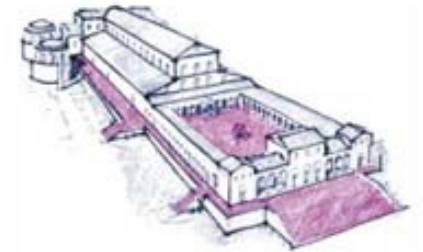

## Arquitetura Românica

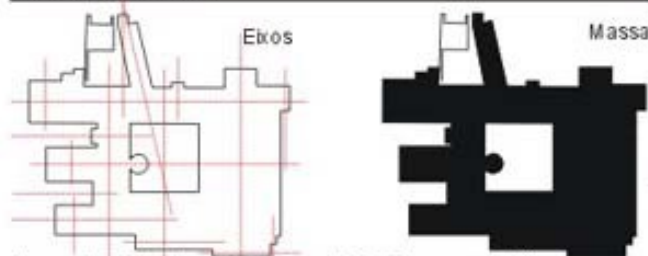

Alemanha - Abadia do Mosteiro de Maulbronn, sec. XII

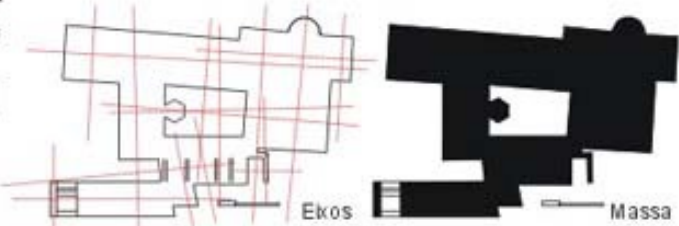

França, Toulouse - Mosteiro de Le Thoronet, 1136



Suíça. Mosteiro de St. Gall, 816  
St. Gall. Maquete - Um mosteiro ideal

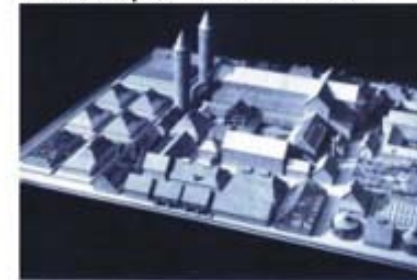



Arquitetura Gótica

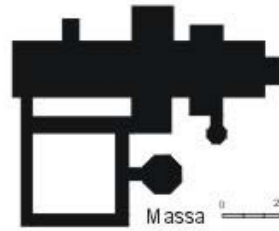
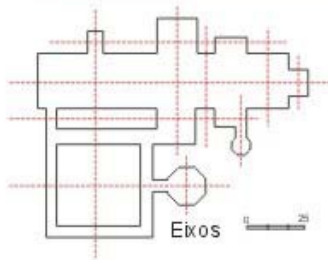

Inglaterra - Catedral de Salisbury, 1220-26

Arquitetura Turca

Turquia, Erzerum - Madrasa Cifte Minare Medrese, 1253

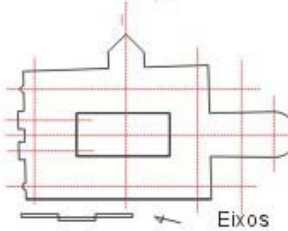
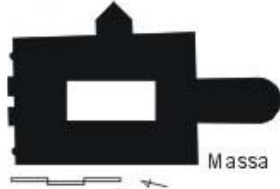

Turquia, Edirne - Külliye de Selim II, 1568-73

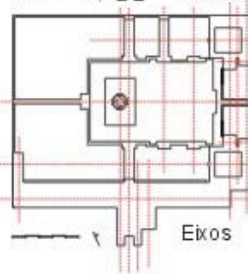
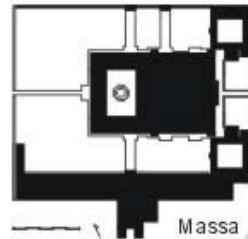

Turquia, Edirne - Mesquita Ütch Cherefeli Djami, 1437-47

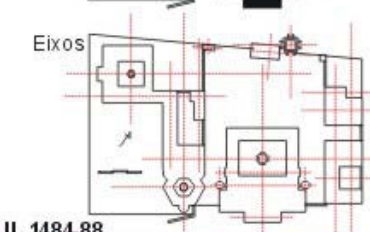
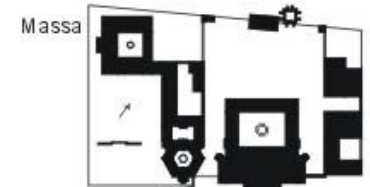
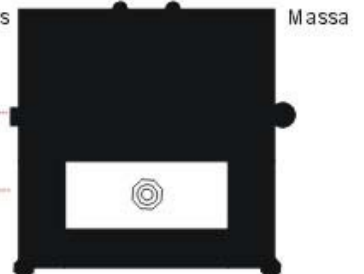
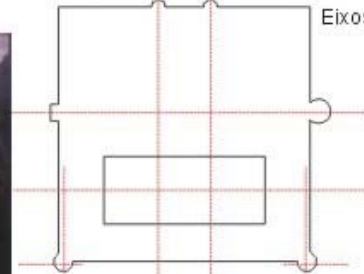

Turquia, Edirne - Külliye de Bayazid II, 1484-88



Arquitetura Renascentista

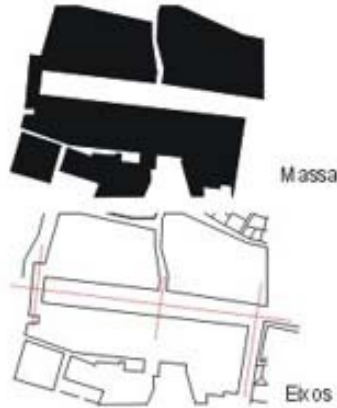
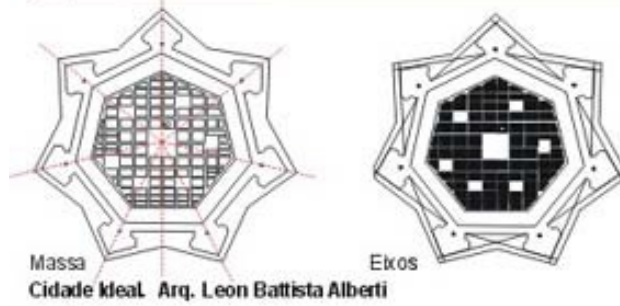

Itália. Florença Galeria Uffizi, 1560-80



Cidade Ideal. Pintura. Museu do Vaticano. Roma

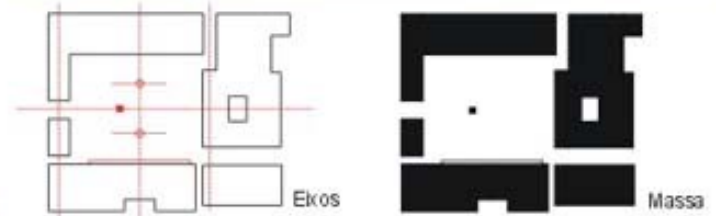

Itália. Florença Piazza Annunziata ---



Arquitetura Maneirista

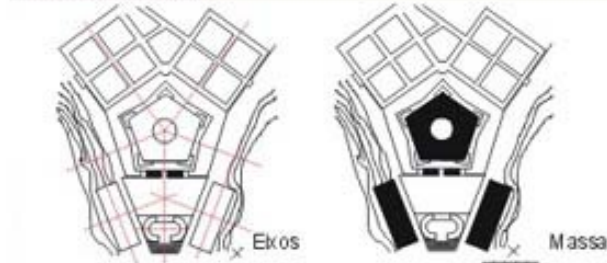

Itália. Caparola  
Palácio Farnese, 1559



Arquitetura Barroca

Itália. Roma Piazza de San Pedro, 1657-67

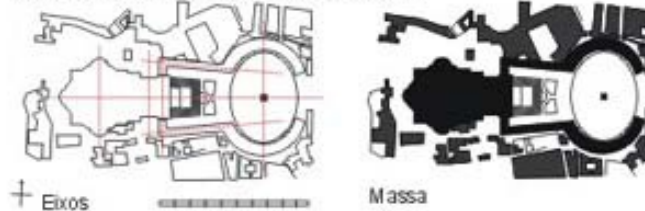

França. Paris - Place Vendôme, 1699-1720





Arquitetura Barroca



França. Paris - Place Vauban, 1704-1720



Austria. Viena - O Belvedere, 1714-22

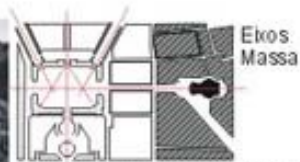

França. Paris - Praça da Concorde, 1755-75



Arquitetura no século XVIII - XIX - A Era da Ilustração

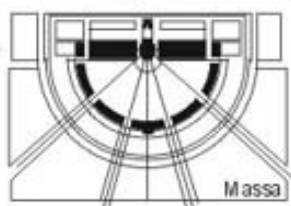
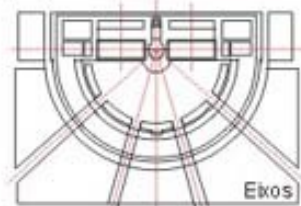

França (Besançon) - Cidade de Chaix, 1775-79



Arquitetura no século XVIII - XIX - Tratados e Intervenções



Cidade-Jardim, 1898  
Ebenezer Howard

Espanha. Barcelona. Intervenção de Ildefonso Cerdà, 1859

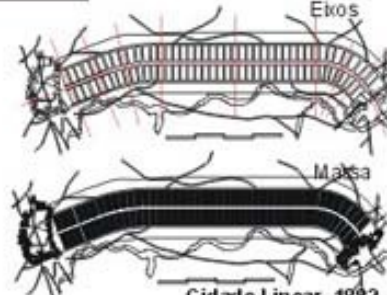
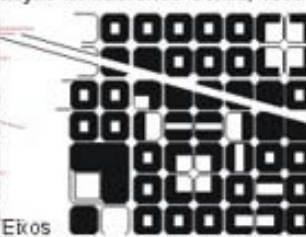
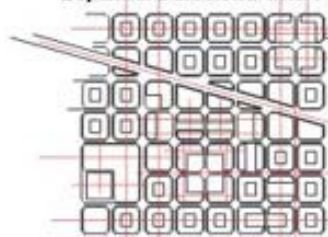

Cidade Linear, 1882  
Arturo Soria e Malta

Familiário de Guisa, 1859-70

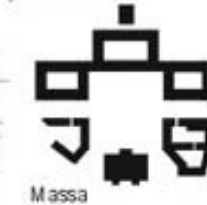
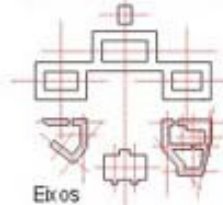

França. Paris. Intervenções Haussmannianas, 1859-70

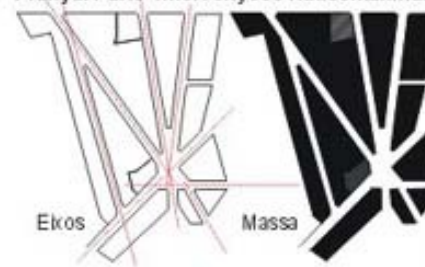

Paris. Vista aérea, 1996



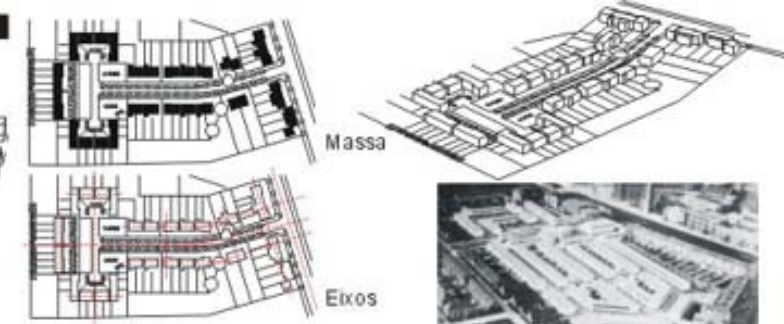
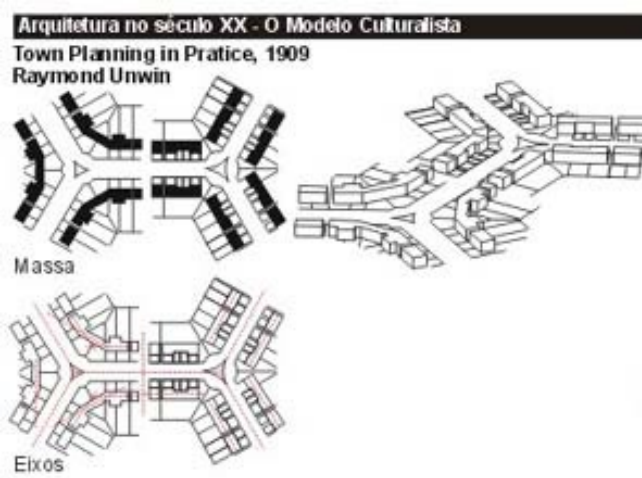

**Holanda. Roterdã**  
**Bairro Kiefhoek, 1925**  
 Arq. J. P. Oud

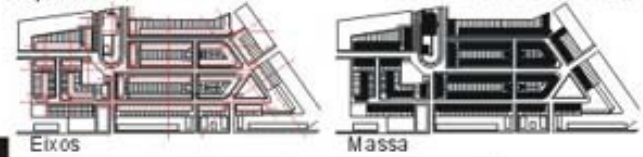

**Arquitetura no século XX - O Modelo Racionalista**  
**França. Caen - Bairro de Hérouville, 1961**  
 Arq. Candilis-Josic-Woods.

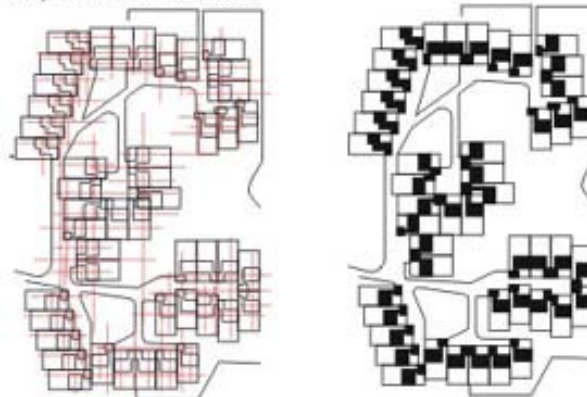

**Foto Maquete. Área institucional**



**Arquitetura no século XX - Pós-modernismo**

**Alemanha. Stuttgart - Staatsgalerie de Stuttgart, 1977-83**

Arq. James Stirling

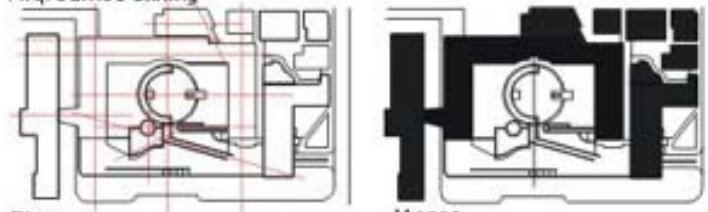

Eixos

Massa



**Arquitetura Contemporânea**

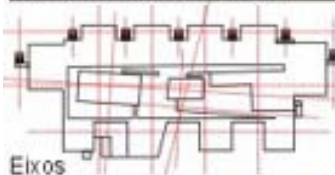

Eixos



Massa

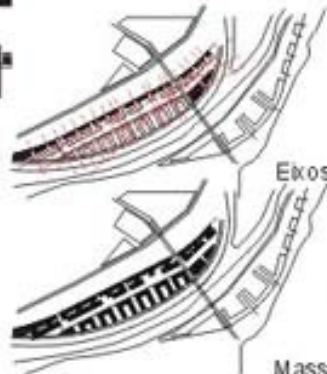

Massa França. Paris - Renault Master Plan, 1995



**França. Mame-La Vallée - Escola de Arquitetura, 1994-96**

Arq. Bernard Tschumi

# Categoria Espacial 03

Arquitetura Egípcia

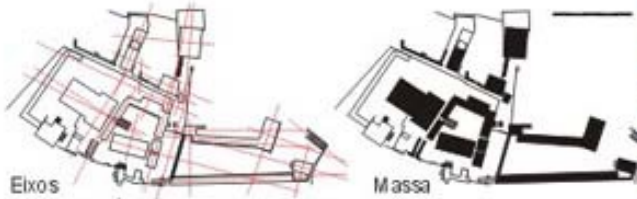

Templo de Ísis - Ilha de Philae, sec. IV a.C.



Arquitetura Grega

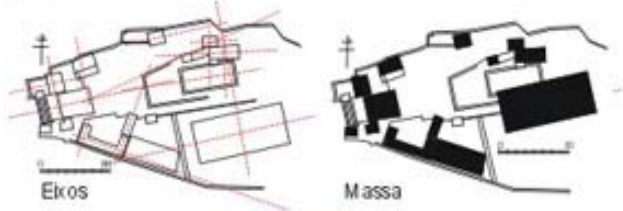

Atenas - Acrópolis, sec. IV a.C.

Arquitetura Romana

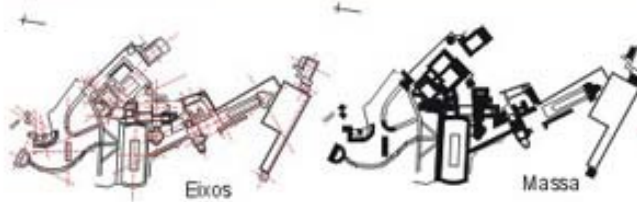

Tivoli - Vila Adriano, 118 d.C.



Assos - Ágora, sec. II a.C.



Atenas - Ágora, 100 a.C.

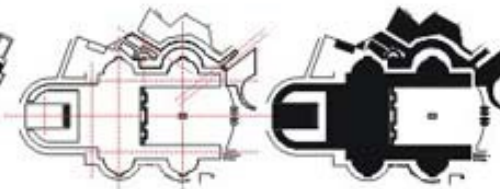

Roma - Foro de Trajano, 100 d.C.



Arquitetura Gótica

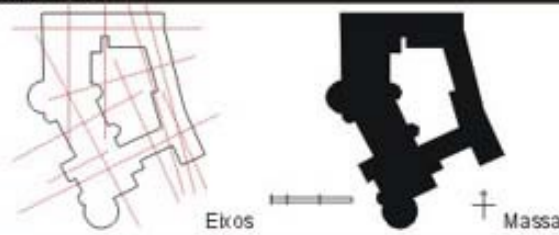

França - Bourges / Casa Jacques Coeur, 1443-51



Arquitetura Turca

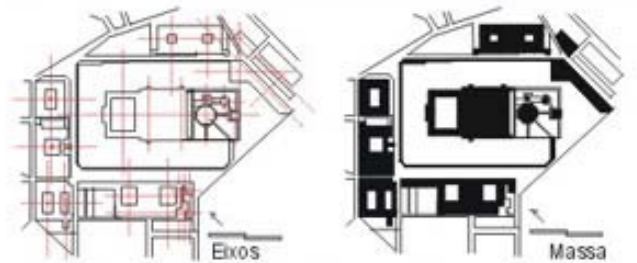

Turquia. Stambul - Külliye de Solimão, 1550-66



Pátio central da mesquita

Arquitetura Renascentista

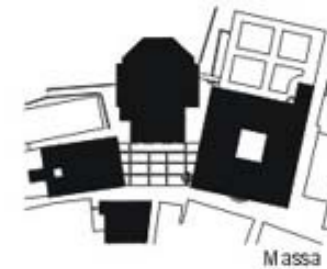
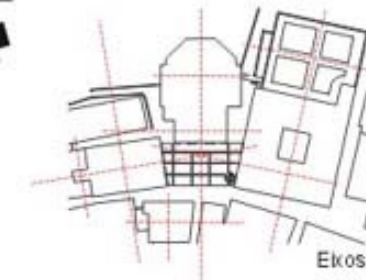
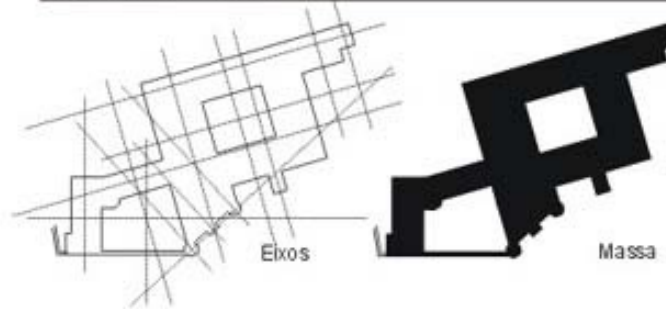

Itália. Urbino Palazzo Ducale, 1450  
Novo Palazzo Ducale. Pátio interno.



Itália. Pienza Praça principal, 1459-62  
Piazza Pienza. Vista desde a loggia do Palazzo Comunale





Arquitetura Maneirista

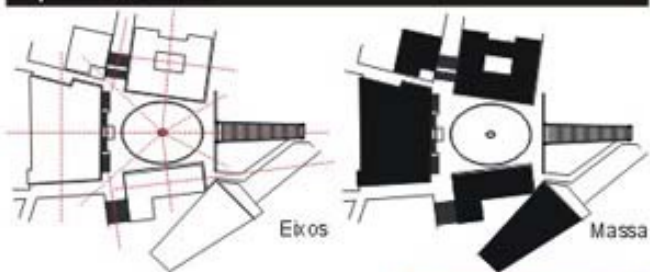

Itália. Roma. Praça do Capitólio, 1544  
Michelangelo

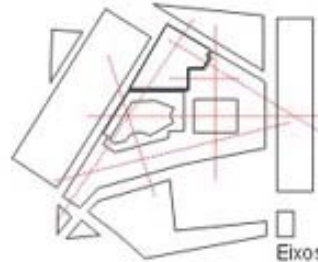

Itália. Roma - Palácio Borghese, 1586



Itália. Roma - Quirinal, 1748  
Quirinal. Piazza di Monte Cavallo



Arquitetura Barroca

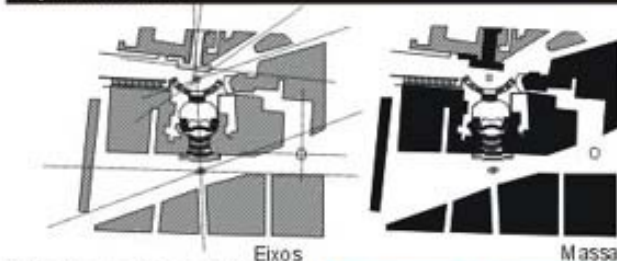

Itália. Roma. Piazza di Spagna, 1721-25



Arquitetura no século XX - O Modelo Culturalista

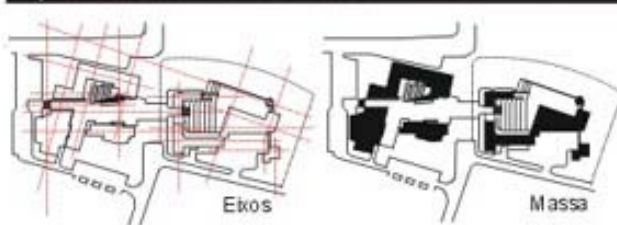

Finlândia. Seinäjoki - Centro Urbano, 1958  
Arq. Alvar Aalto

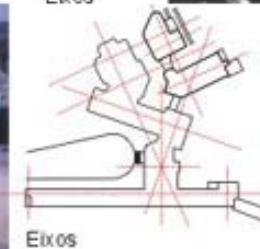

Sanatório para tuberculosos de Paimio, 1929-1933  
Arq. Alvar Aalto



Arquitetura no século XX - O Modelo Culturalista (cont.)

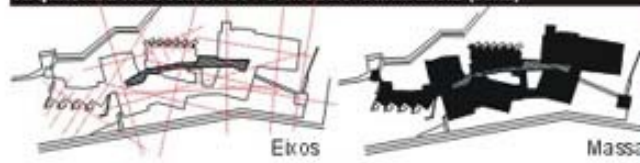

Alemanha, Darmstadt - Darmstadt School, 1951  
Arq. Hans Sharoun

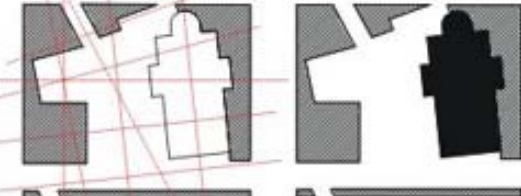

Itália, Palermo - Praças Europeias, sec. XIX  
Estudos Camillo Sitte

Arquitetura no século XX - Pós-modernismo

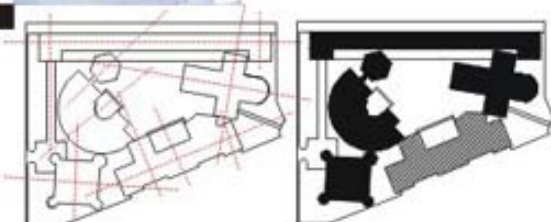
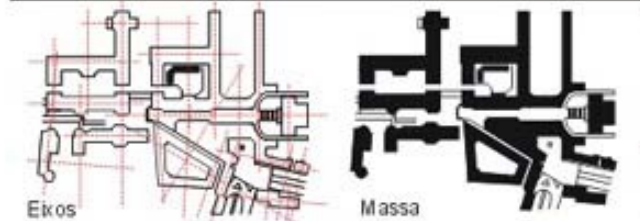

Alemanha, Berlim - Centro Científico, 1978-87  
Arq. James Stirling



Alemanha - Charlottenplatz, 1972  
Arq. Rob Krier

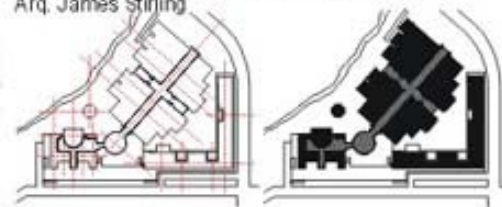
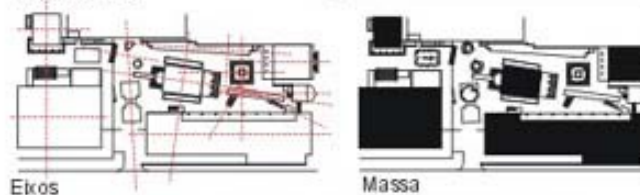

Alemanha, Berlim  
Museu Alemão de História, 1987  
Arq. Aldo Rossi



E.U.A., Los Angeles - Faculdade de Direito Loyola, 1981-84  
Arq. Frank Gehry

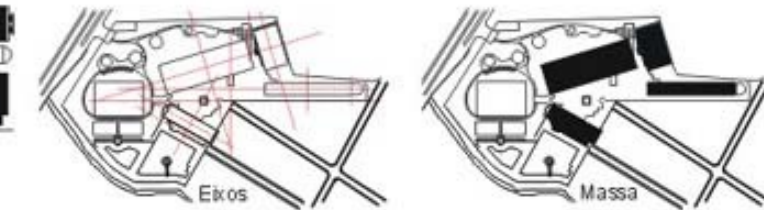

Brasil, Nova Iguaçu-RJ  
Sesc Nova Iguaçu, 1985  
Arq. Bruno Padovano  
Arq. Hector Vigliecca





Arquitetura Contemporânea

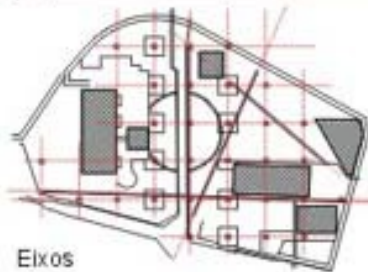

Eixos

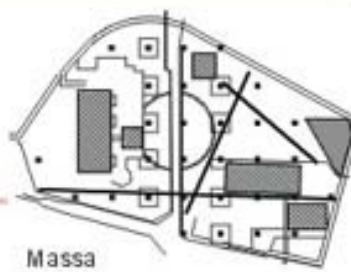

Massa

**França, Paris**  
**Parc de la Villette, 1982**  
Arq. Bernard Tschumi



Fotografia G.A. Docine et al.

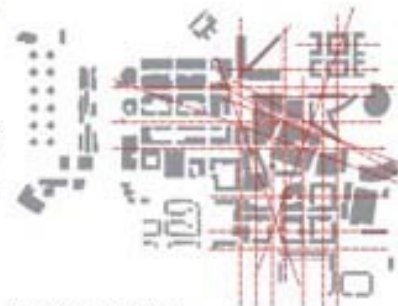

**Holanda, Almere**  
**Reordenação Urbana, 1994**  
Arq. Rem Koolhaas

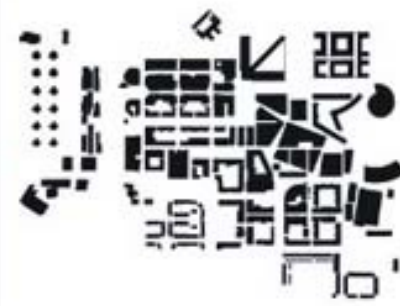

Eixos



Massa



**Alemanha, Düsseldorf**  
**Bairro Derendorf Norte, 1992**  
Arq. Peter Eisenman



**Alemanha, Frankfurt**  
**Parque Rebstock, 1992**  
Arq. Peter Eisenman

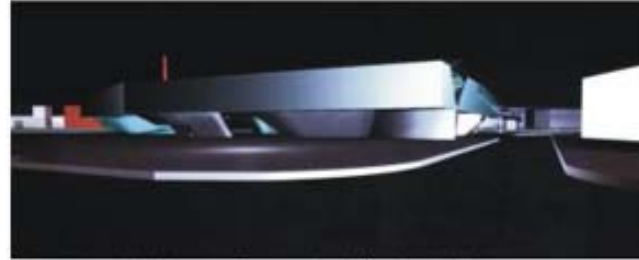
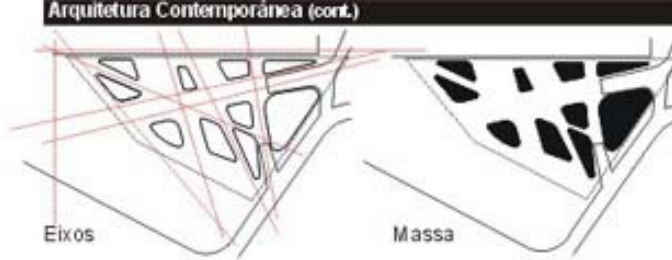

Alemanha, Wolfsburg - Centro da Ciência, 2000  
Arq. Zaha Hadid

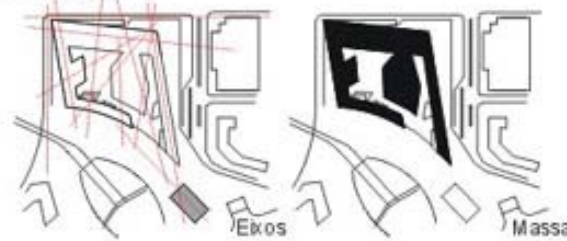

— Zaha Hadid: The Complete Buildings and Projects

Reino Unido, País de Gales  
Ópera Cardiff, 1994  
Arq. Zaha Hadid

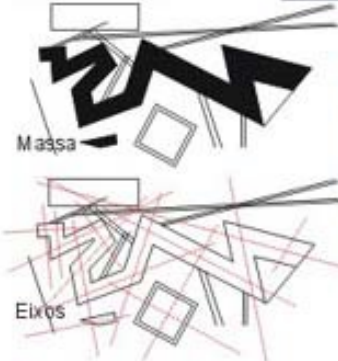

Alemanha, Berlim  
Museu Judaico, 1989-92  
Arq. Daniel Libeskind

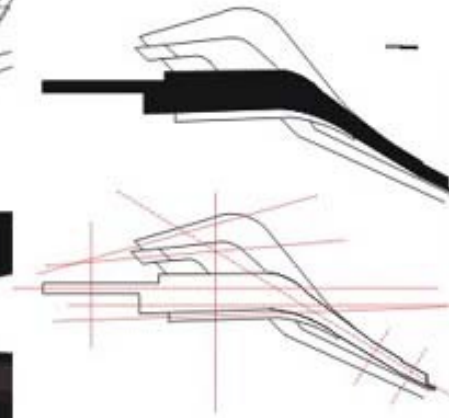

Alemanha, Weill am Rhein - Lfone / LANDESGARTENCHAU, 1997  
Arq. Zaha Hadid



Eixos Massa

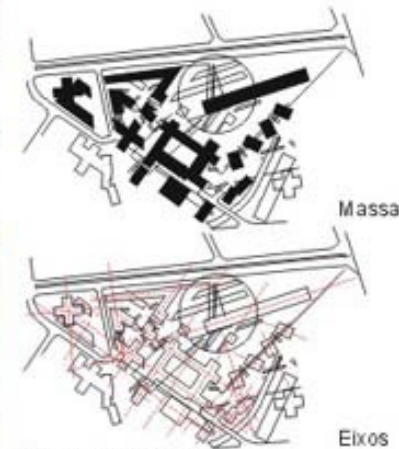

Alemanha, Berlim  
Landsberger Allee/Rhinstrasse, 1995  
Arq. Daniel Libeskind



Alemanha, Berlim  
Alexanderplatz, 1993  
Arq. Daniel Libeskind



Leitura Urbana Estudos de Caso

**Categoria Espacial 01**





PROGRAMA:  
SUPERFICIE: 13 HA  
800 VIVIENDAS: (120.000 M<sup>2</sup>)  
DENSIDAD: 62 VIVIENDAS POR HECTÁREA  
APARCAMIENTO SUBTERRÁNEO: 37.500 M<sup>2</sup>  
OTROS USOS: 20.000 M<sup>2</sup>

- 1 OMA: APARCAMIENTO CHASSÉ.  
APARCAMIENTO PÚBLICO CON 670 PLAZAS. DA  
SERVICIO AL TEATRO, A LAS OFICINAS MUNICIPALES  
Y AL CENTRO DE LA CIUDAD.
- 2 XAVER DE GEYTER: VIVIENDAS EN EL PARQUE.  
MEDIO ANILLO SEMIHUNDIDO QUE HACE DE ZÓCALO  
PARA CINCO TORRES DE VIVIENDAS.
- 3 HANS KOLLHOFF: EL PALACIO. MANZANA DE  
VIVIENDAS EN LA PLAZA DEL MUSEO.
- 4 VAN SAMBEEK AND VAN VEEN: VILLAS CON PATIO.
- 5 DUINKER VAN DER TORRE: VIVIENDAS-INVERNADERO.
- 6 EEA (ERICK VAN EGERAAT): PEQUEÑA SALA DE  
CONCIERTOS.
- 7 PASCAL GROSFELD: VIVIENDAS Y OFICINAS DEL  
MUSEO Y REHABILITACIÓN DEL PROPIO MUSEO.

- 8 VAN SAMBEEK AND VAN VEEN: VIVIENDAS EN  
NONNENVELD.
- 9 FRITS HAVERMAN: AMPLIACIÓN DEL HOTEL KEIJSER.
- 10 STURM ARCHITECTEN: DE BEELDENAAR. TIENDAS,  
SUPERMERCADOS Y VIVIENDAS.
- 11 OMA: EDIFICIO DE VIVIENDAS CARRÉ.  
VARIOS VOLÚMENES ALREDEDOR DE UN JARDÍN  
INTERIOR.
- 12 KRAAIJVANGER URBIS ARCHITECTEN: HOLLAND  
CASINO EN LA KLOOSTERKAZERNE.
- 13 THEO VAN ESCH: VIVIENDAS DEL TEATRO.  
TRES MANZANAS CON VIVIENDAS ADOSADAS.
- 14 KUIPER COMPAGNONS: VIVIENDAS EN EL CANAL.
- 15 KRAAIJVANGER URBIS ARCHITECTEN: HOTEL.
- 16 CLAUS EN KAAAN: TERCERAS OFICINAS MUNICIPALES.  
EL EDIFICIO ESTÁ SUSPENDIDO PARA MANTENER LAS  
VISTAS SOBRE EL CHASSÉ TERRAIN.
- 17 WEST 8 LANDSCAPE ARCHITECTS: PAISAJISMO.
- 18 HERMAN HERTZBERGER. TEATRO CHASSÉ.  
TERMINADO CON ANTERIORIDAD AL PLAN GENERAL  
DEL CHASSÉ TERRAIN.

Plano urbano: OMA  
Año\_1996  
Antigua área militar  
Novo programa habitacional

**Plan general de ordenación**  
Master plan  
1:5000





# Conjunto Habitacional\_Xaveer de Geyter\_Breda\_Holanda.2001

**Conceitos relevantes:** Percurso Caminhar **Estaticidade** Dinamismo Assimetria **Simetria** Percepção ativa Sobreposição Conexão



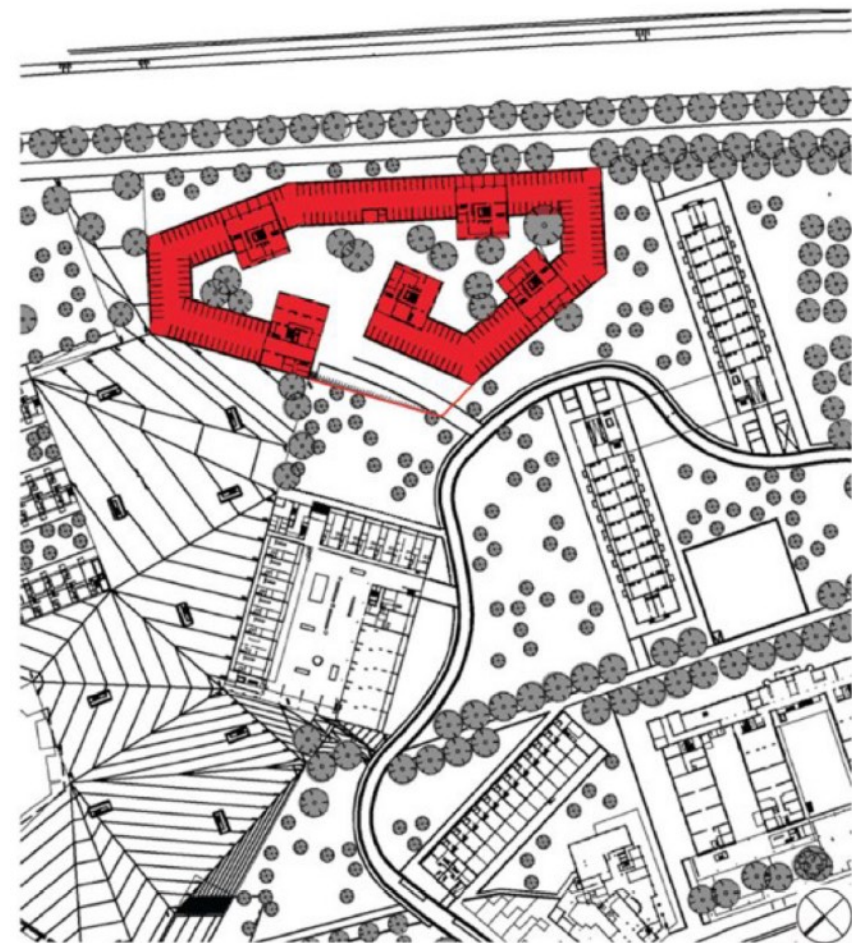

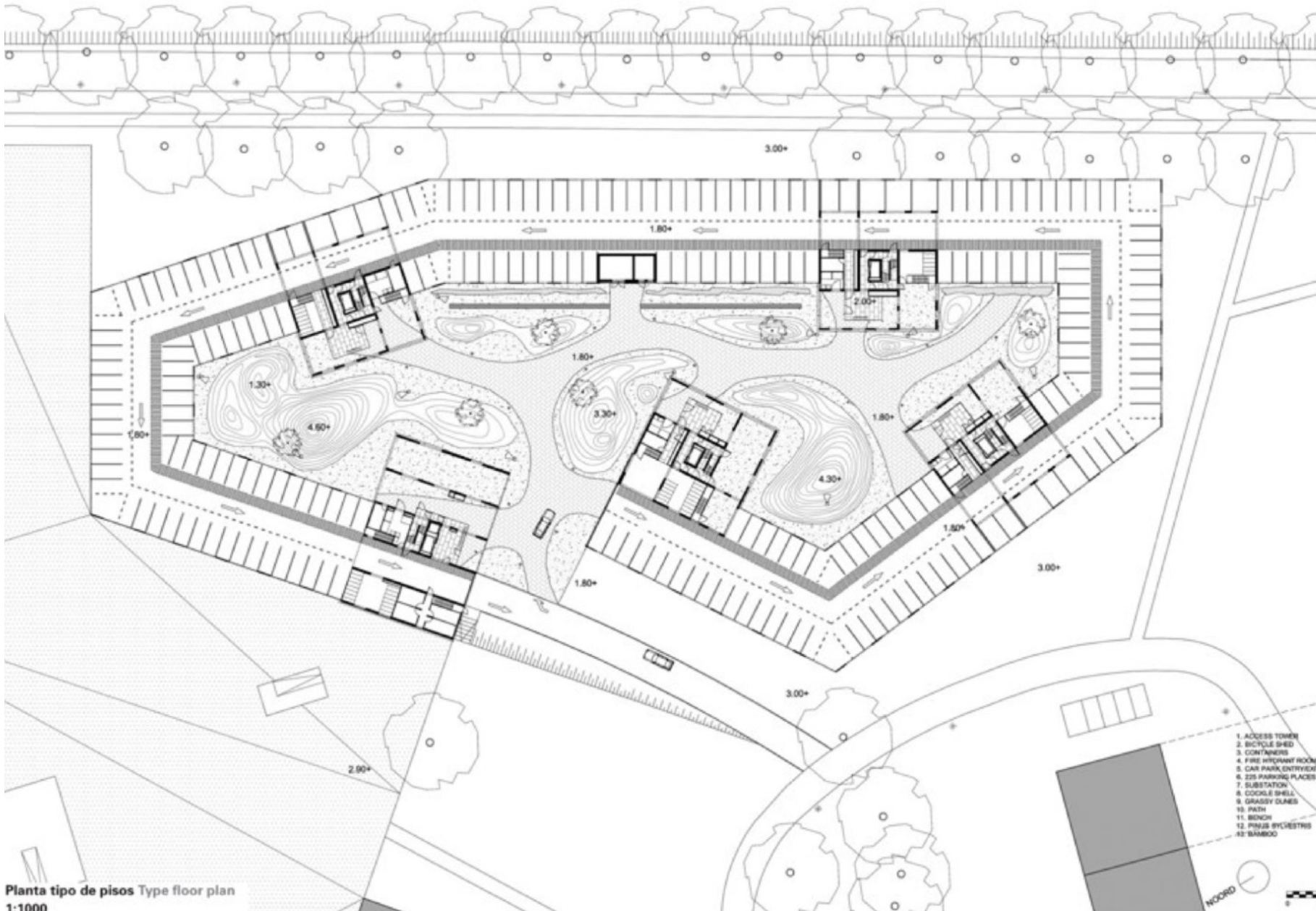



a+t research group\_This is Hybrid







Leitura Urbana Estudos de Caso

**Categoria Espacial 02**

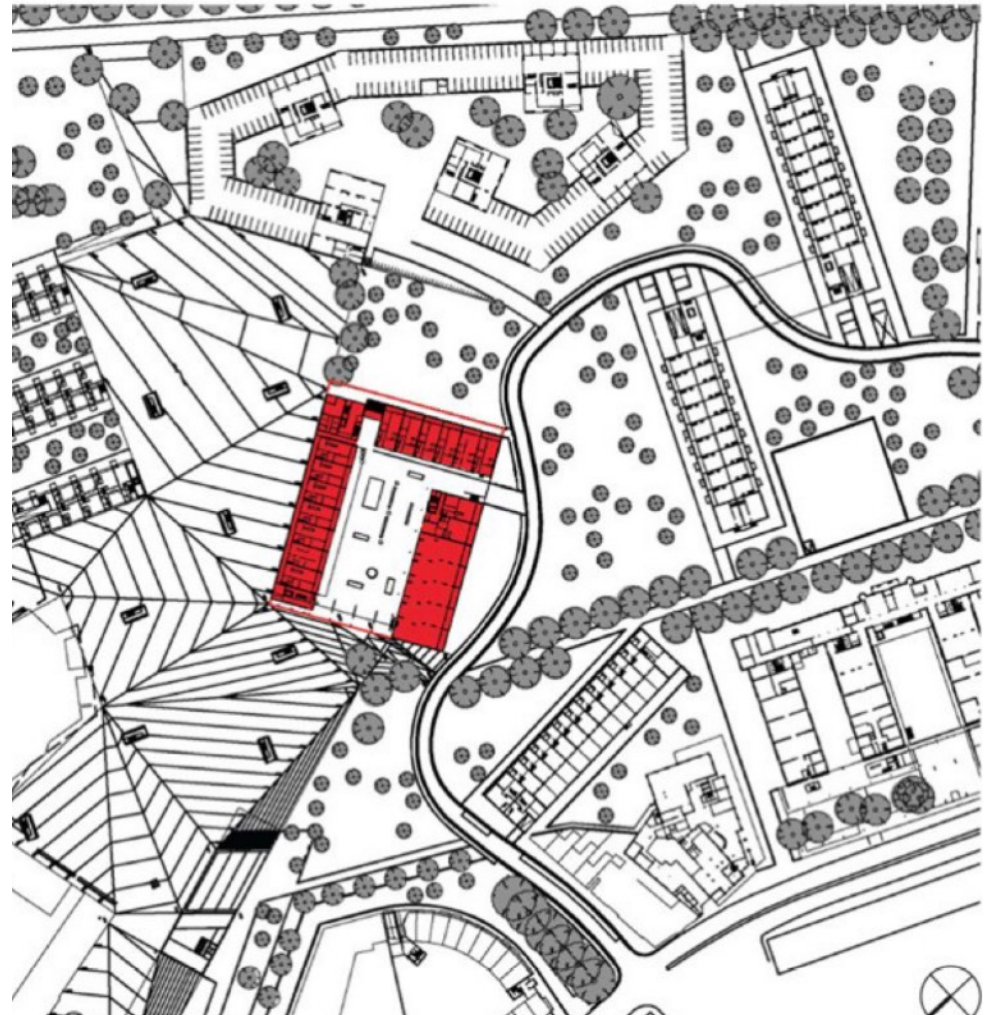





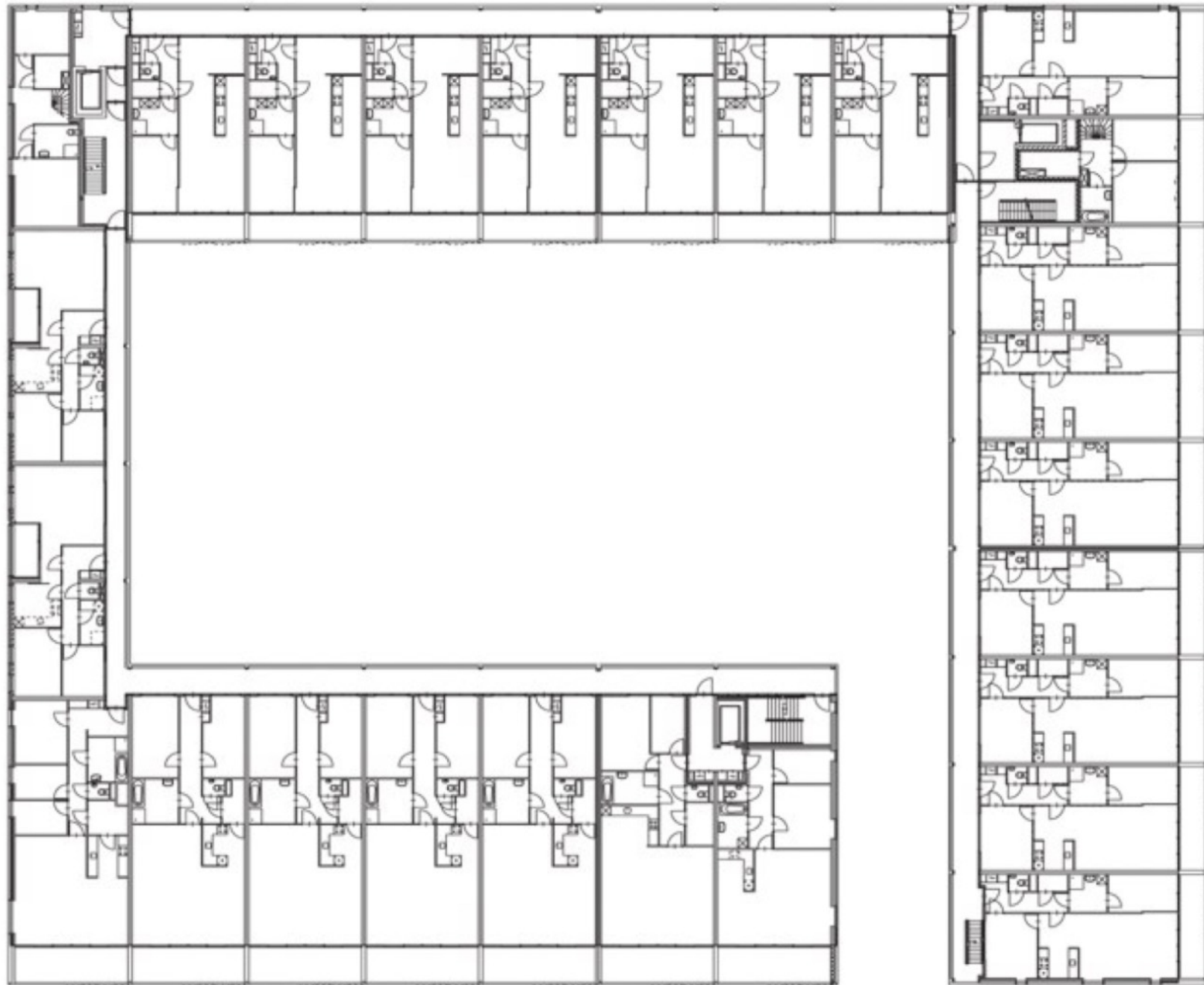

Planta segunda y tercera Second and third floor plan 1:500









a+t research group\_This is Hybrid



# Edifício Multifuncional\_BCMF\_BeloHorizonte.2018

**Conceitos relevantes:** **Percurso** **Caminhar** **Estaticidade** **Dinamismo** **Assimetria** **Simetria** **Percepção ativa** **Sobreposição** **Conexão**



[www.arcoweb.com.br](http://www.arcoweb.com.br)



BCMF Arquitetos: Edifício de uso misto, Belo Horizonte, MG

**ARQUITETURA QUE REQUALIFICA A  
CIDADE**

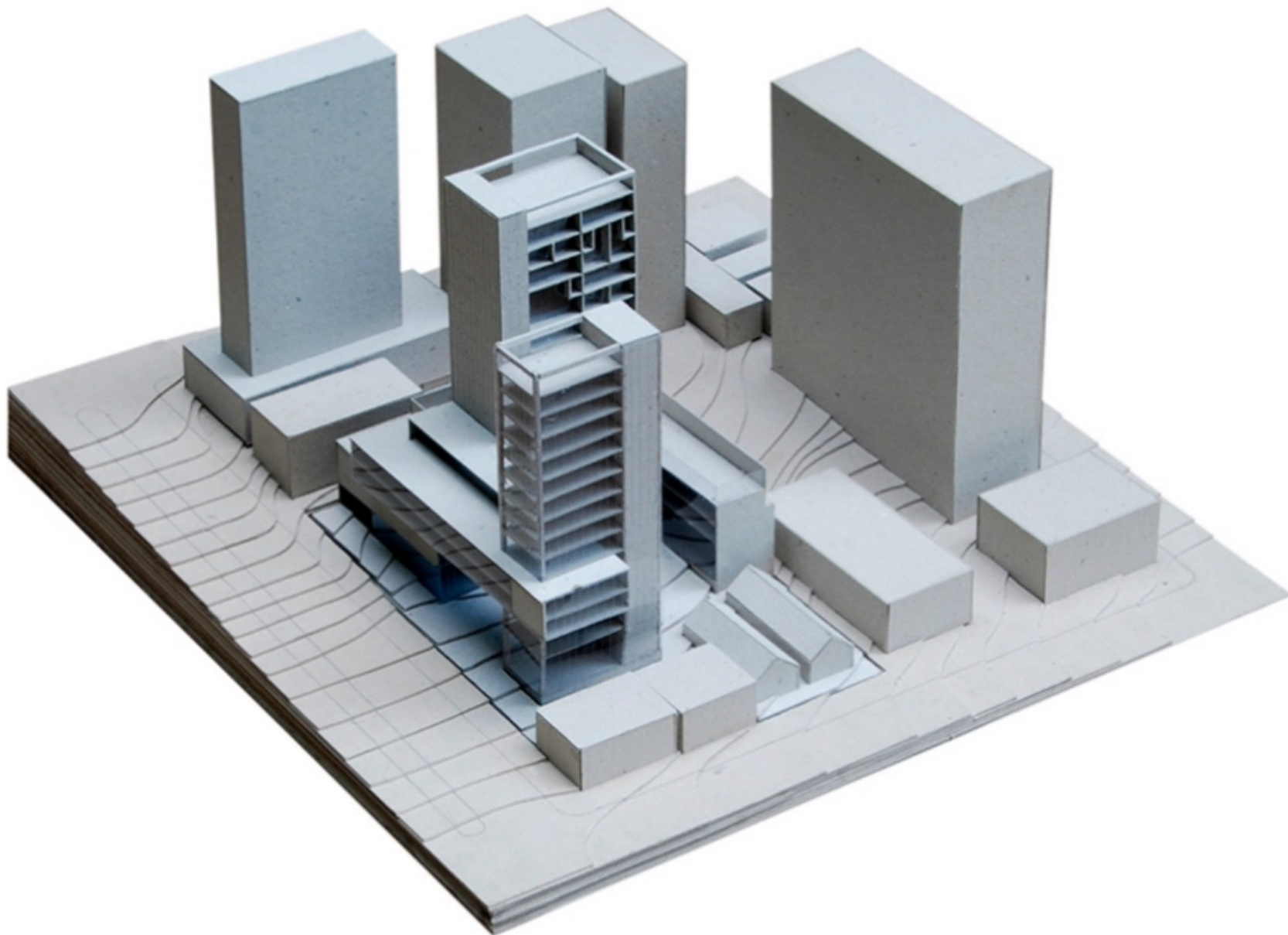

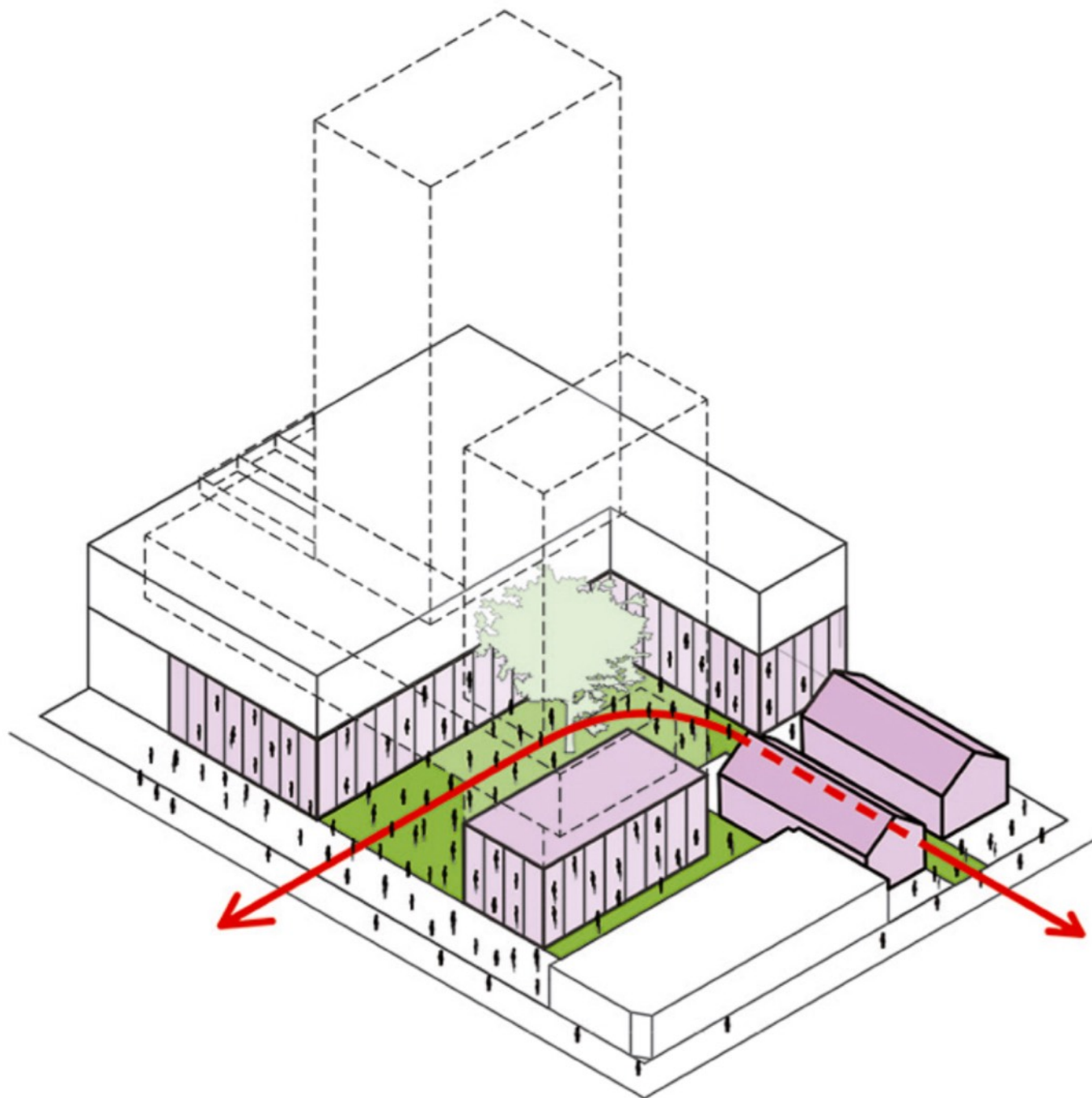



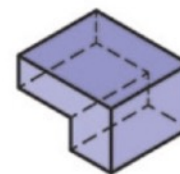
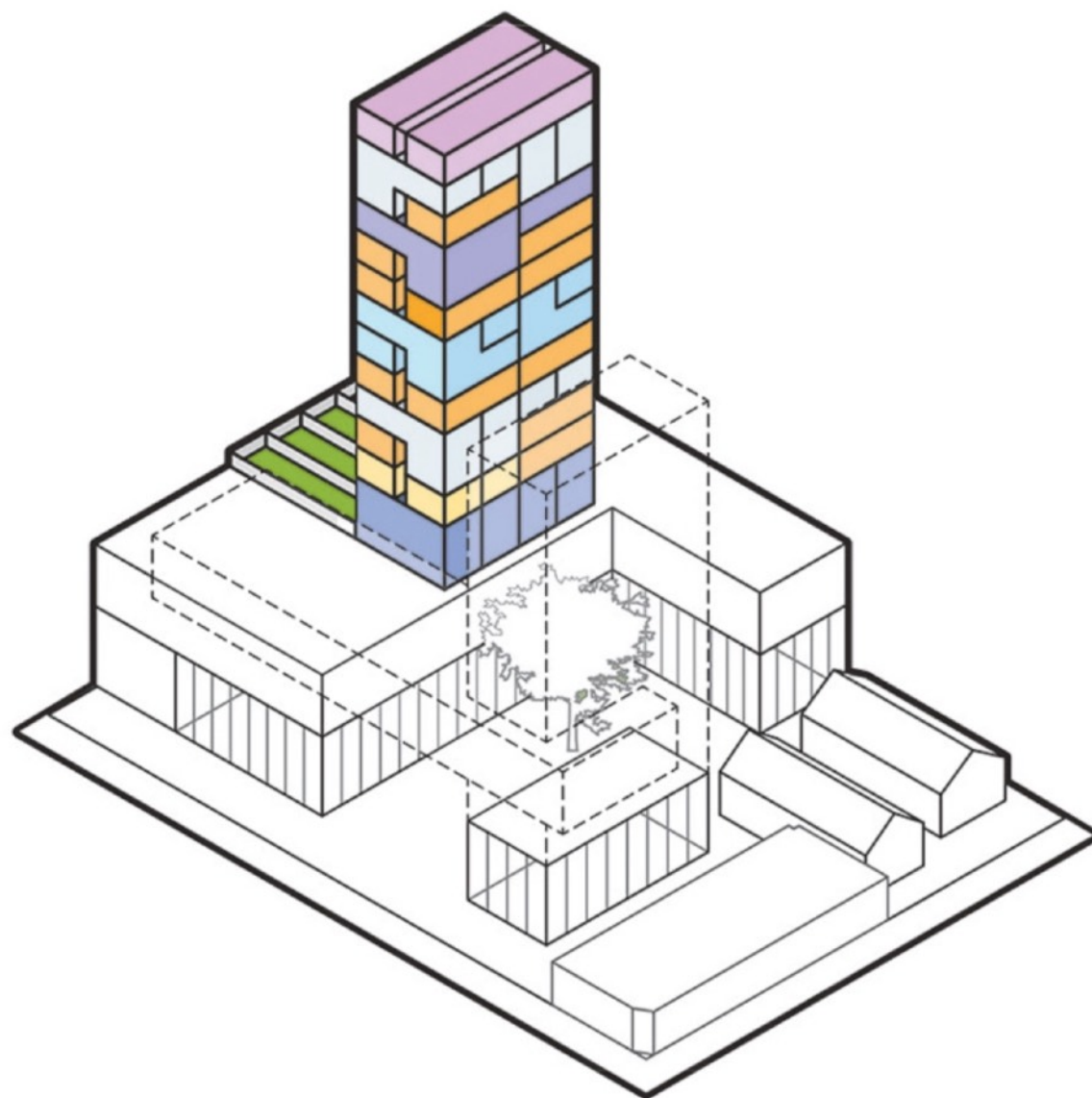

XL

ÁREA: 140 M<sup>2</sup>

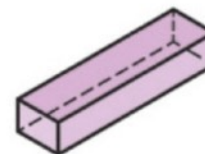

L

ÁREA: 124 M<sup>2</sup>

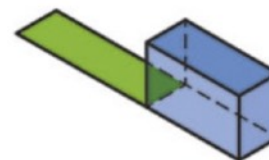

MLP

ÁREA: 126 M<sup>2</sup>

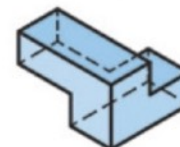

ML

ÁREA: 95 M<sup>2</sup>

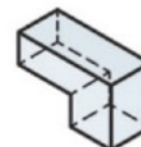

M

ÁREA: 75 M<sup>2</sup>

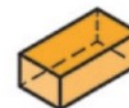

S

ÁREA: 64 M<sup>2</sup>



XS

ÁREA: 30 M<sup>2</sup>

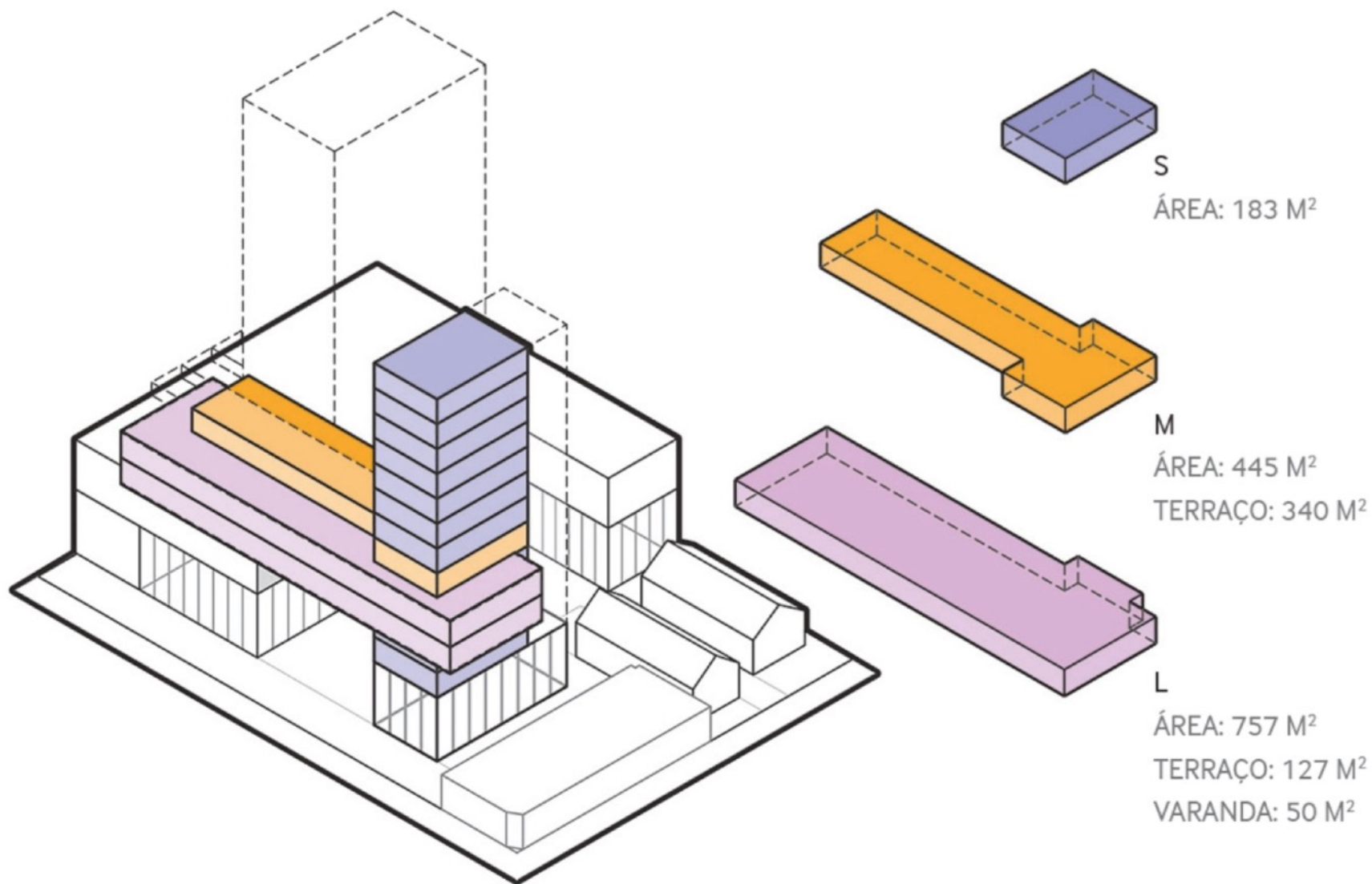











Leitura Urbana Estudos de Caso

**Categoria Espacial 03**



Conceitos relevantes: **Percurso** **Caminhar** **Estaticidade** **Dinamismo** **Assimetria** Simetria Percepção ativa **Sobreposição** Conexão



a+t research group\_This is Hybrid

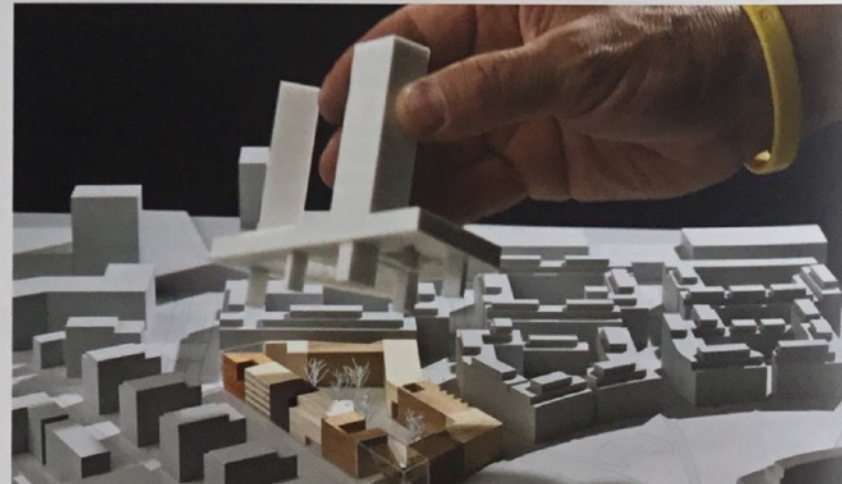
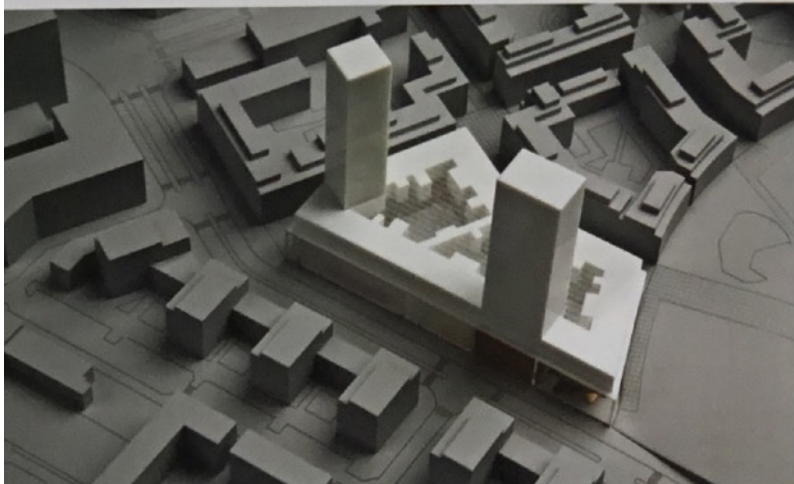

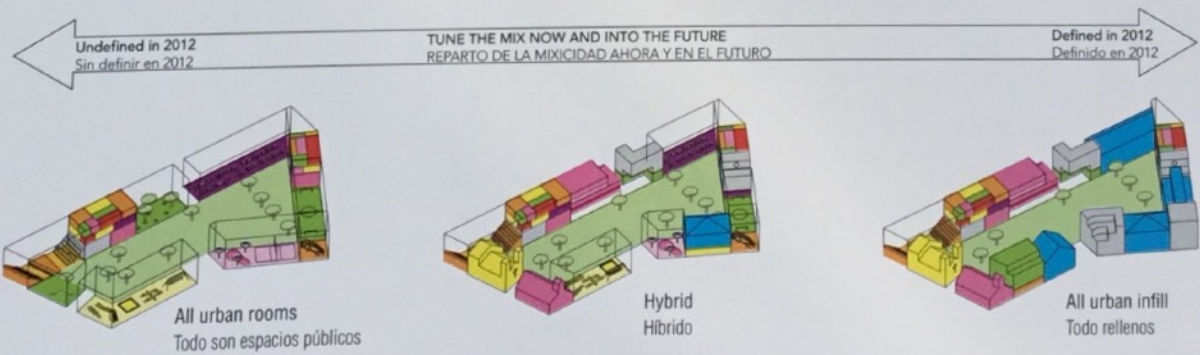
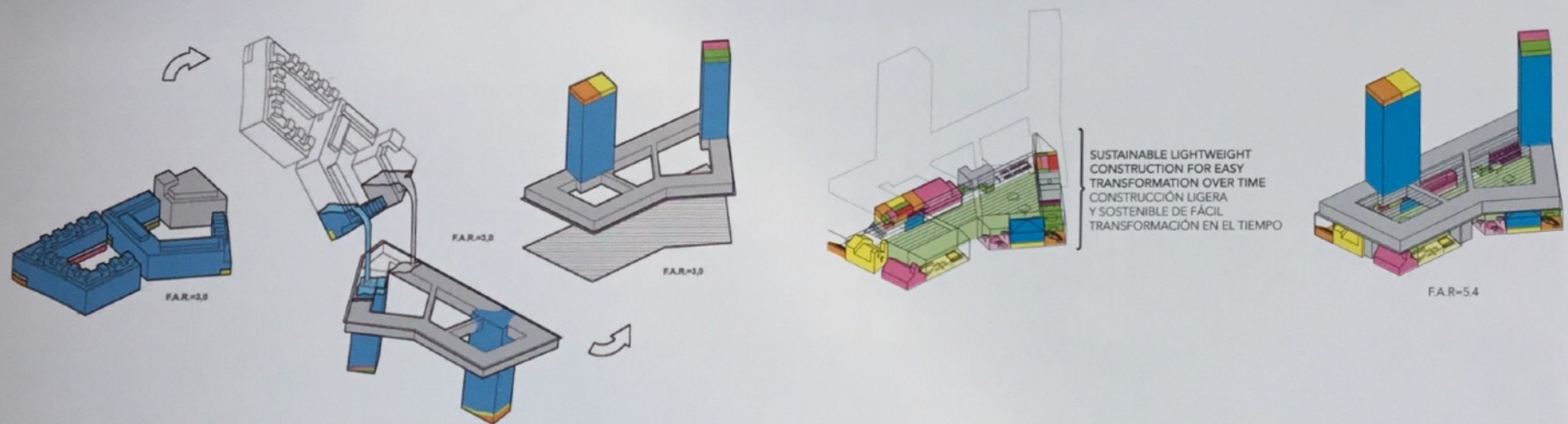







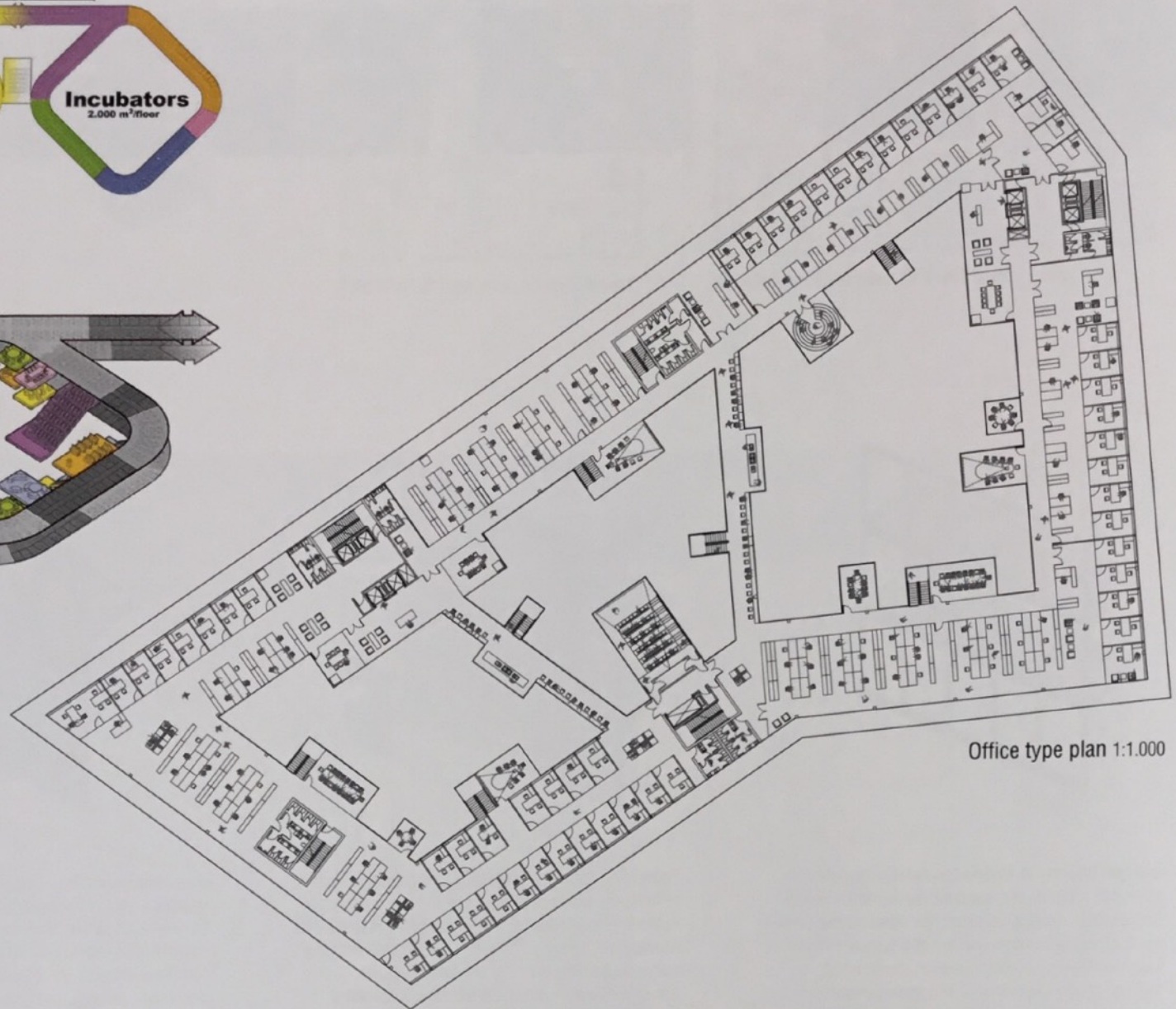
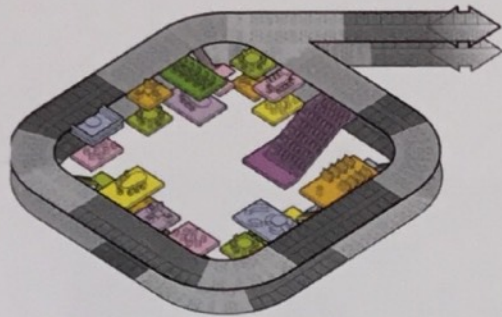
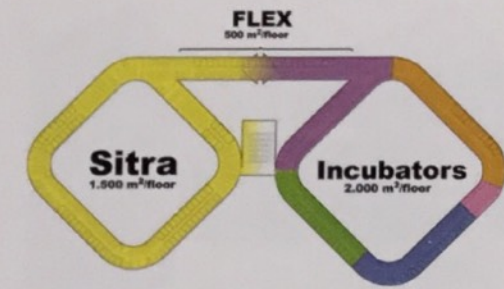

Office type plan 1:1.000

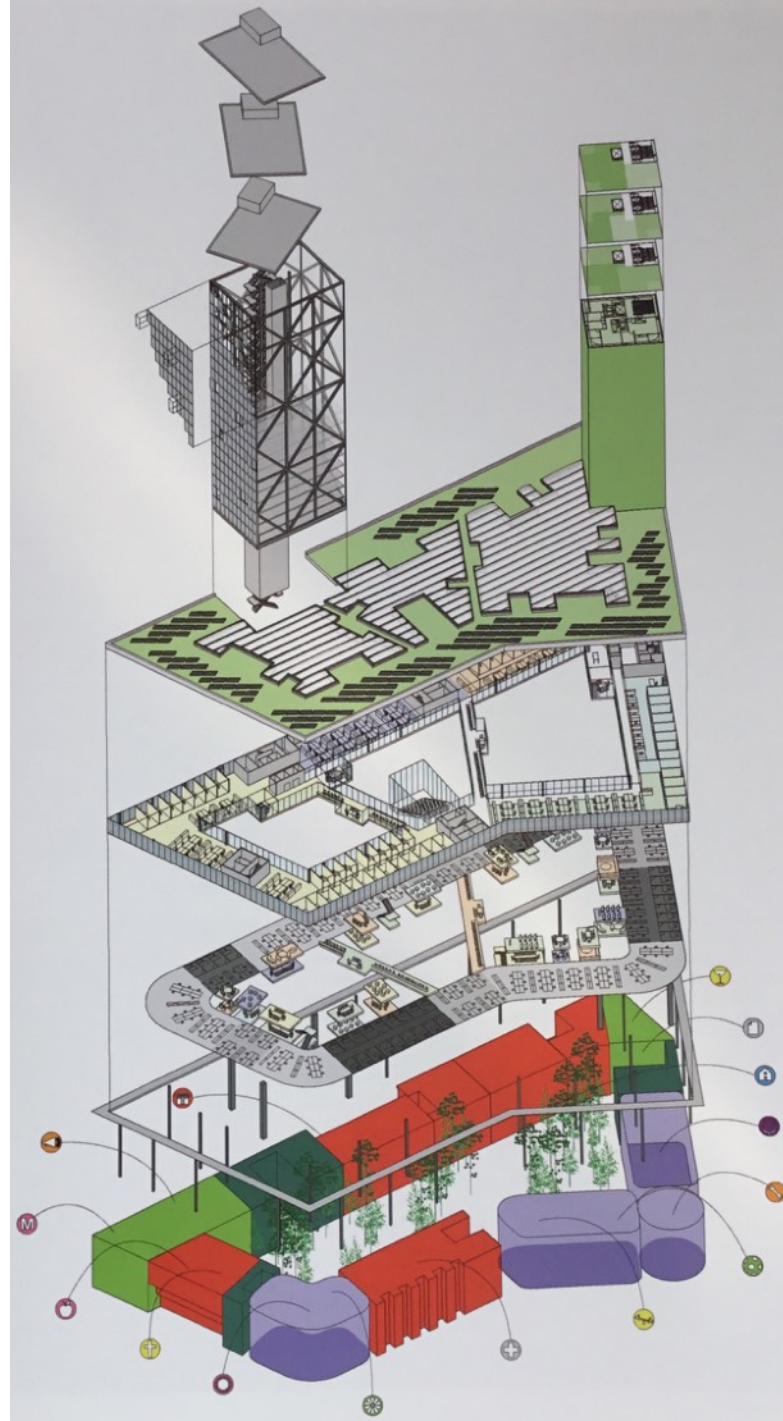



Conceitos relevantes: **Percurso** **Caminhar** **Estaticidade** **Dinamismo** **Assimetria** Simetria Percepção ativa **Sobreposição** Conexão



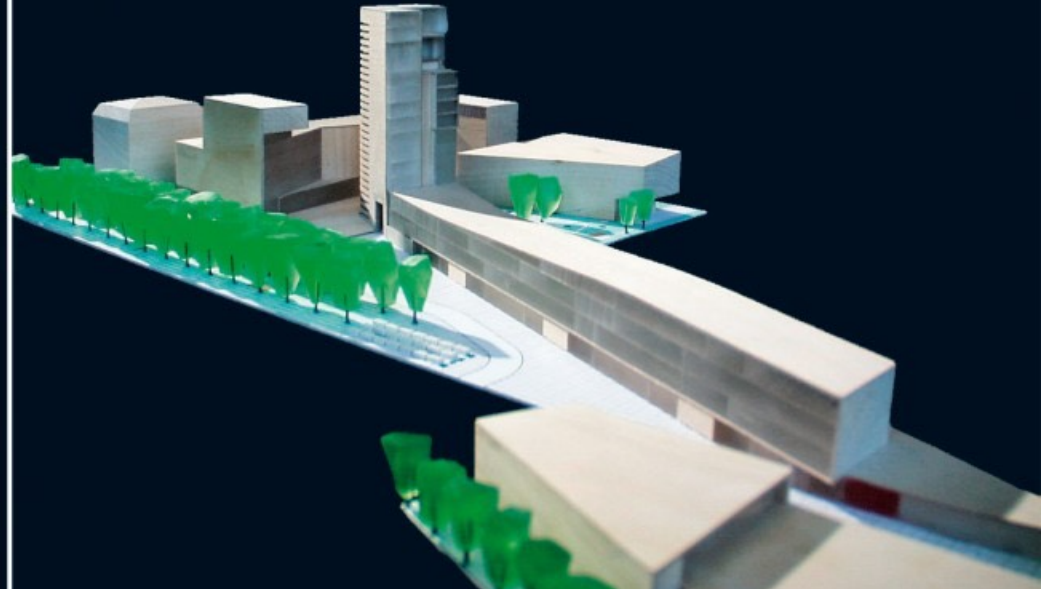
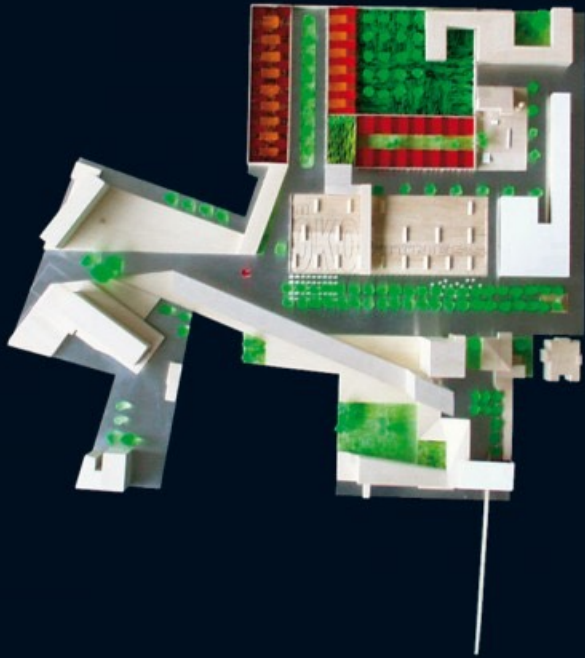

<https://bolles-wilson.com>









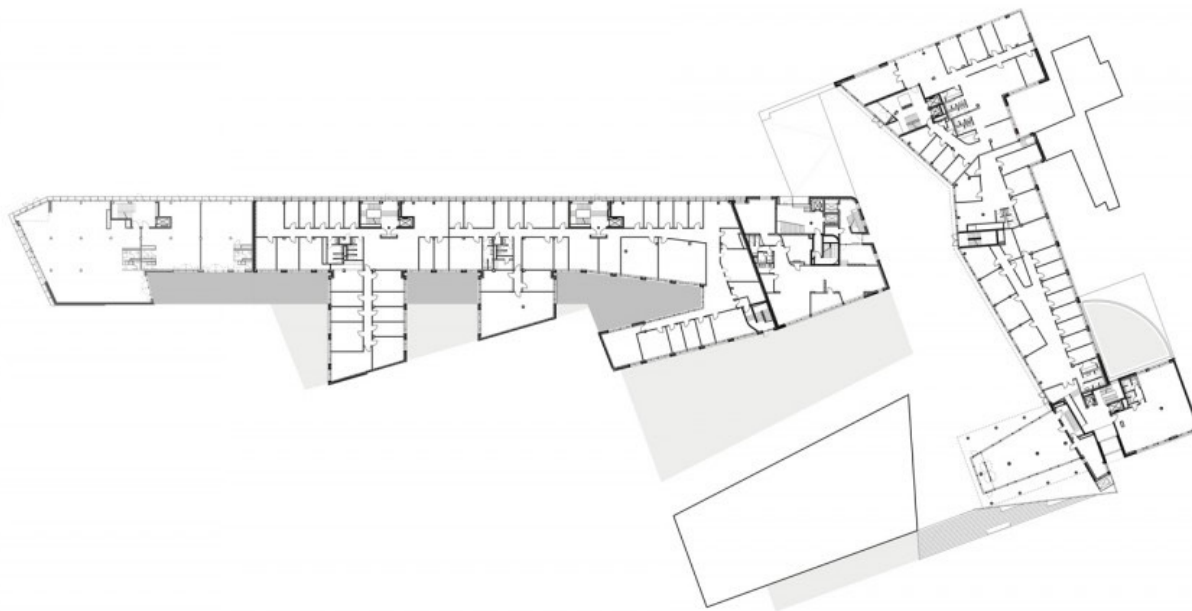

Planta pavimento térreo

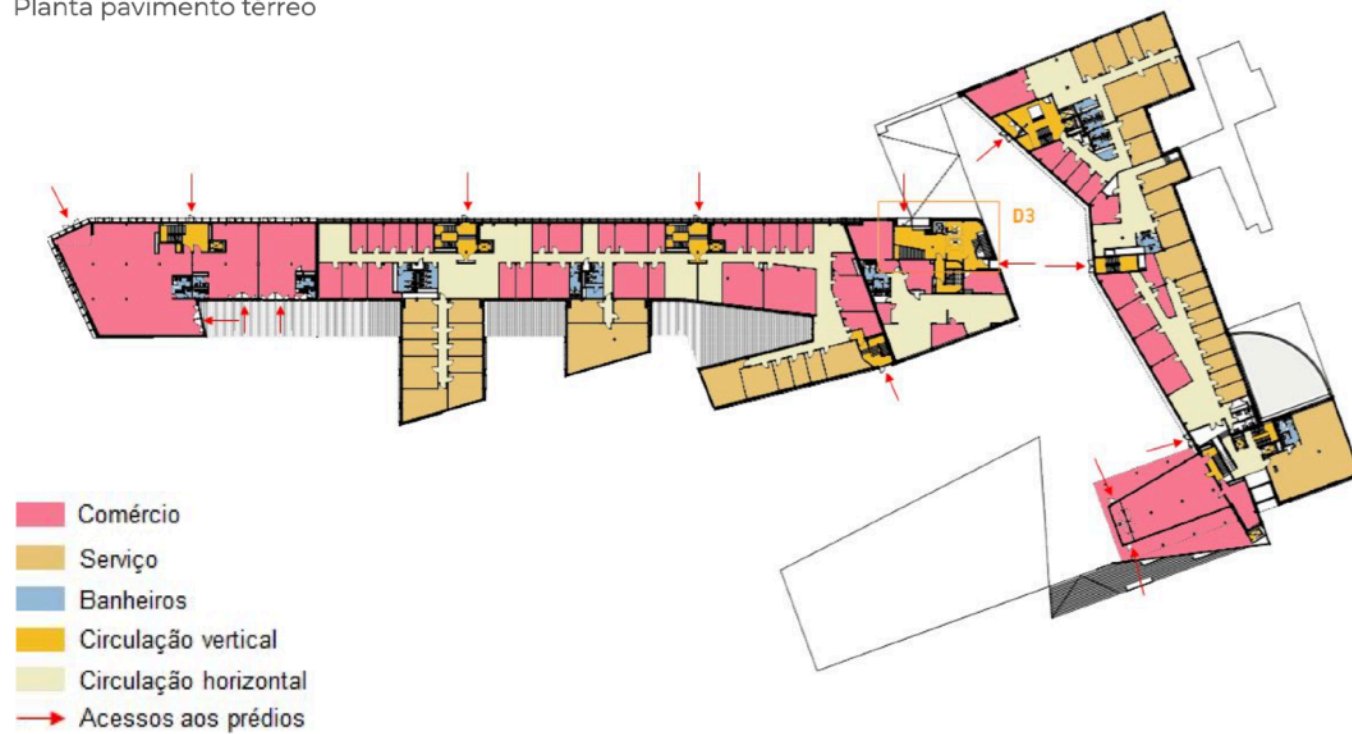



















**film**